



Contents

Contents	1
Preface	2
Service	2
Warranty	2
1 Safety Instructions	3
2 Proper use	4
3 Inspection	4
3.1 Receiving Inspection	4
3.2 Listing of Items	4
4 Trial run	4
5 Operation	5
5.1 Continuous Operating	5
5.2 Touch Operating	5
6 Maintenance and Cleaning	6
7 Associated Standards and Regulations	6
8 Technical Data	7
9 Products and Accessories	7

Vortex Mixers (Adjustable and Fixed Speed Models)

821100069999	-F6 fixed speed Vortex, with VT 1.1 Standard Attachment, UK plug 220v/50Hz	821200049999	6-9S adjustable speed Vortex, with VT 1.1 Standard Attachment, USA plug, 110v/60Hz
821100079999	6-F6 fixed speed Vortex, with VT 1.1 Standard Attachment, Euro plug, 220v/60Hz	821200059999	6-9S adjustable speed Vortex, with VT 1.1 Standard Attachment, Euro plug, 220v/50Hz
821100089999	6-F6 fixed speed Vortex, with VT 1.1 Standard Attachment, UK plug, 220v/60Hz	821200069999	6-9S adjustable speed Vortex, with VT 1.1 Standard Attachment, UK plug, 220v/50Hz
821100159999	6-F6 fixed speed Vortex, with VT 1.1 Standard Attachment, USA plug, 220v/60Hz	821200099999	6-9S adjustable speed Vortex, with VT 1.1 Standard Attachment, Euro plug, 220v/60Hz
821100169999	6-F6 fixed speed Vortex, with VT 1.1 Standard Attachment, USA plug, 220v/50Hz	821200109999	6-9S adjustable speed Vortex, with VT 1.1 Standard Attachment, UK plug, 220v/60Hz
821200019999	6-9S adjustable speed Vortex, with VT 1.1 Standard Attachment, Cn plug, 220v/50Hz	821200159999	6-9S adjustable speed Vortex, with VT 1.1 Standard Attachment, USA plug, 220v/60Hz
821200029999	6-9S adjustable speed Vortex, with VT 1.1 Standard Attachment, Cn plug, 220v/60Hz	821200169999	6-9S adjustable speed Vortex, with VT 1.1 Standard Attachment, USA plug, 220v/50Hz
821200039999	6-9S adjustable speed Vortex, with VT 1.1 Standard Attachment, USA plug, 110v/50Hz		

Vortex Mixers (Adjustable and Fixed Speed Models)

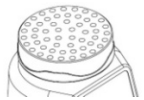
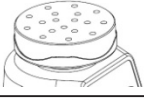
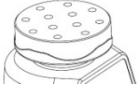
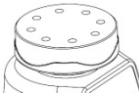
Accessories			
	Cat.No and Designation	Serviceable range	Operation mode
	18900034 VT1.1 standard top	For test tubes and small vessels upto diameter 30 mm	Continuous /touch operation
	18900035 VT1.3 universal top plate	100 mm-plate attachment with rubber pad	Continuous operation
	18900020 VT1.3.1 tube adapte	For 48 Eppendorf tubes	Continuous operation
	18900021 VT1.3.2 tube adapter	For 18 test tubes Ø10mm for VT 1.3	Continuous operation
	18900022 VT1.3.3 tube adapter	For 12 test tubes Ø12mm , for VT 1.3	Continuous operation
	18900023 VT1.3.4 tube adapter	For 8 test tubes Ø16mm, for VT 1.3	Continuous operation



	18900024 VT1.3.5 tube adapter	For 8 test tubes Ø20mm, for VT 1.3	Continuous operation
	18900043 VT1.3.6, platform pad	For $\lt; \text{Ø}99 \text{ mm}</math> tubes and small vessels$	Touch operation

Table 4

NOTE: VT1.3 ~ VT1.3.5 adapter and pad are only suitable to MX-S Adjustable speed Vortex Serial Number and pattern number and accessories names on the type plate must be supplied when ordering other accessories.

Changing attachment

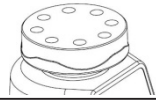
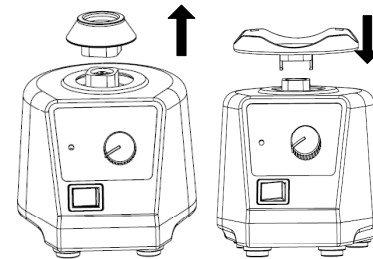

Figure 5